

2019-20

Milton Catholic Secondary Panel School Boundary Review

School Boundary Review Process - An Overview

What is a School Boundary Review Process?

- A process to create and/or alter school attendance area that define the service areas of a school.
- Creation of school attendance areas/boundaries are based on a Criteria approach, which are as follows:
 1. Optimizing the use of existing school facilities;
 2. Minimizing the use of portable classrooms whenever possible;
 3. To the extent possible, minimize school boundary adjustments over the long-term;
 4. Optimize school transportation and maximizing walkers to school;
 5. Ensure that classroom organizations are sustainably sized; and,
 6. Give due consideration to the concept of a neighbourhood and Catholic School community.

School Boundary Review Process - An Overview

Why is a School Boundary Review Needed in Milton?

- Both secondary schools in Milton are FULL, requiring a new secondary school.
- There is inadequate space in existing secondary schools in the Town of Milton at present to accommodate growth in wait for the new Milton #3 CSS to open in 2022
- Staff expects a response from the Ministry in spring 2020, confirming project funding
- A School Boundary Review Process is needed to:
 1. Create an interim school boundary solution to accommodate Secondary Students Accommodation in Milton for the 2021 school year until Milton #3 CSS opens
 2. Create the final school boundary for the future Milton #3 CSS school community

School Boundary Review Process - An Overview

Who Participates in the Process?

- A School Boundary Review Committee (SBRC) involves the following members:
 1. Catholic School Council Chairs (or designates) of the affected school communities;
 2. Designated Family of Schools Superintendent as Chair, and a Co-chair if necessary; and,
 3. Facility Management Services and Planning Services Staff.
- The task of the SBRC is to review potential options and provide objective feedback.
- Once preferred options are identified by the Committee, they are presented to the affected school communities (the public) to gather feedback.
- Once a preferred recommended option is selected, Senior Staff will present the recommended accommodation to Trustees for consideration and approval.

Current Secondary School Boundaries

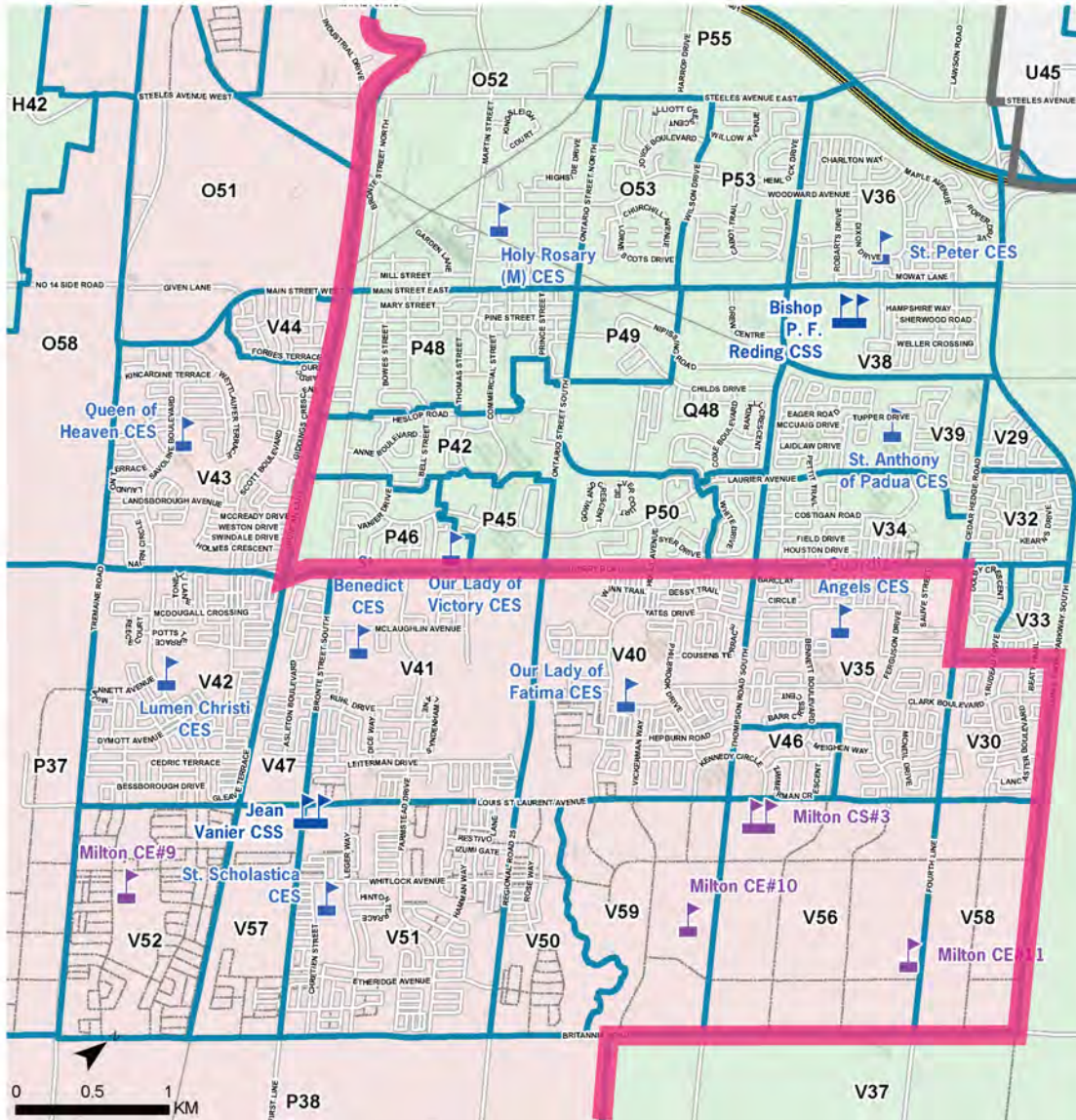

Family of Schools





Bishop P. F. Reding CSS

- Holy Rosary CES
- Our Lady of Victory CES
- St. Peter CES
- St. Anthony of Padua CES

Jean Vanier CSS

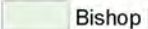
- Lumen Christi CES
- Our Lady of Fatima CES
- Guardian Angels CES
- Queen of Heaven CES
- St. Benedict CES
- St. Scholastica CES
- Milton 9, 10, 11 CES

Legend

 Bishop P. F. Reding CSS	 Jean Vanier CSS
 Elementary School	 Secondary School
 Designated-CES Site	 Designated-CSS Site
 Proposed School	

Milton #3 CSS School Concept

Site Plan Concept

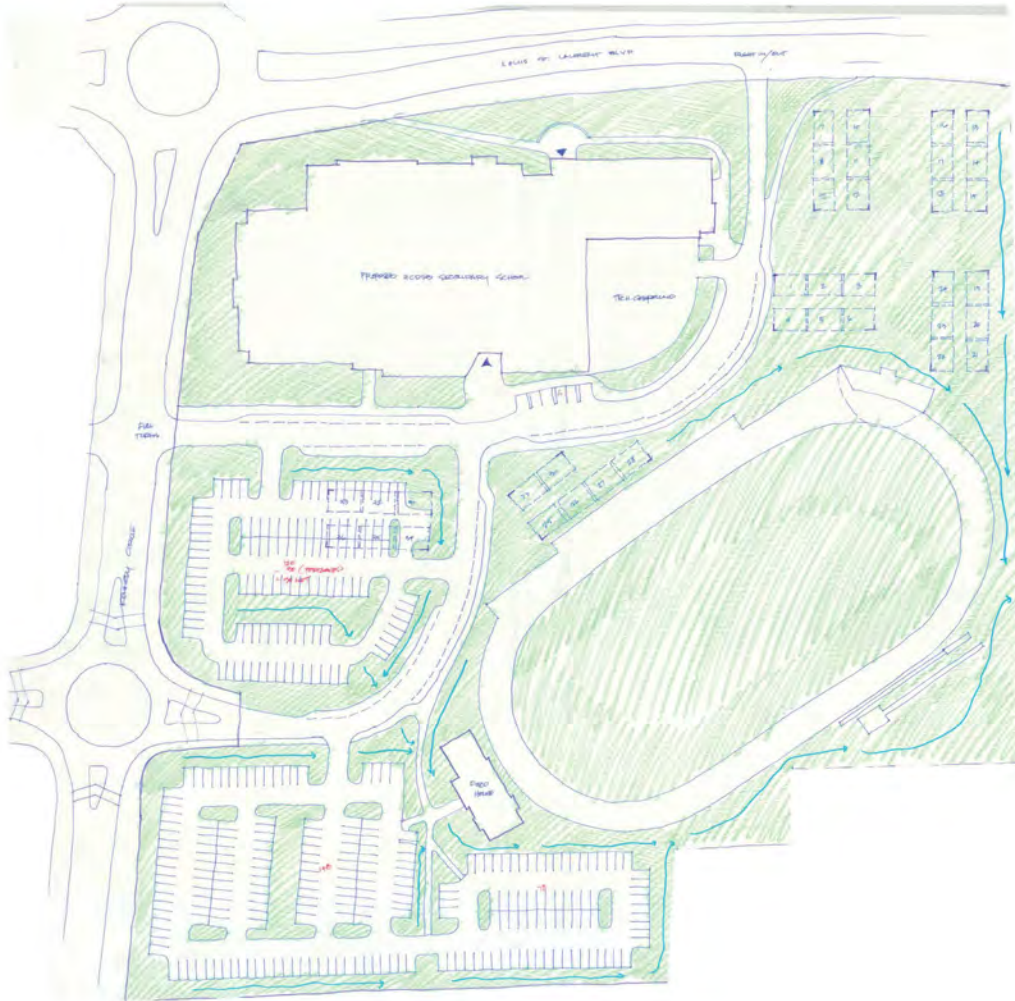

Milton #3 CSS

- 1,542 pupil places
- +/- 18 acre site
- 36 portables capacity
- Running Track

School Location

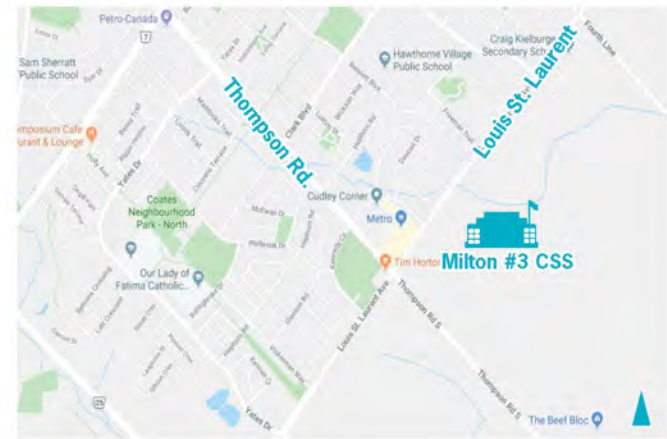

Milton #3 CSS School Concept

School Perspective Drawing



Milton #3 CSS School Concept

School Perspective Drawing



LOUIS ST. LAURENT AVENUE ELEVATION



Next Steps

MILESTONES

1. Staff Report to Initiate Boundary Review
2. Action Report to Initiate Boundary Review
3. Notice for Selection of SBRC Members
4. Milton Parent Council Information Nights
5. Online Webinar
6. SBRC Working Meetings #1, #2
7. Public Meeting #1
8. SBRC Working Meetings
9. Public Meeting #2
10. Final SBRC Working Meeting(s)
11. Staff/Action Recommendation to Board
(May include delegations)

DATES

November 5 2019

November 26 2019

December 2019

January/February 2020

February 2020

Early February 2020

March 2020

March to April 2020

May 2020

Late May to Early June 2020

Late Sept. to Early Oct 2020

Stay Up to Date - Subscribe for Updates and News

†_{SB} SCHOOL PLANNING

[Home](#) [About](#) [Boundary Reviews](#) [Long Term Planning](#) [Projects & Partnerships](#) [Calendar](#) [Contact Us](#)

Milton Catholic Secondary School Boundary Review

Background

On September 30, 2019, the Board submitted its 2019-20 Capital Priorities Submission to the Ministry of Education. The Milton #3 Catholic Secondary School (CSS) project was submitted as Priority #1. It is anticipated the funding announcements will be made in early 2020, at which point the Board will receive confirmation if it was successful.

The 2019 [Long-Term Capital Plan Update](#) indicates that due to Jean Vanier CSS reaching its maximum portable capacity by the 2021-22 school year, the Milton #3 CSS project is required by the same school year. However, seeing as a secondary school takes a minimum of three years to construct, a 2021-22 opening date is not feasible. This may result in Milton #3 CSS students having to be temporarily relocated to alternate school accommodations with available space within the Board's jurisdiction.

As a response to the above concerns, the Board initiated a Secondary School Boundary Review for the Town of Milton secondary panel at the November 26, 2019 Special Board Meeting. Read the full report: [Milton Secondary School Boundary Review Action Report – November 26, 2019](#)



School Boundary Review Committee (SBRC)

If you are interested in serving on the SBRC, please let your School Principal (Milton schools only) know by Thursday, January 9, 2020.

[Presentations/Reports](#) [Meeting Minutes](#)

N/A

Board Resources

[Presentations/Reports](#) [Communications](#)

- [Information Package](#)
- [Action Report – November 26, 2019](#)
- [Staff Report – November 5, 2019](#)

Please Subscribe!

Visit SchoolPlanning.hcdsb.org and subscribe to the website to receive updates on School Boundary Review updates, and what's happening in your school community



Subscribe to updates and additions

First name *

Last name *

Email *

[Subscribe!](#)

Need More Information?



schoolplanning.hcdsb.org



Frederick Thibeault,
Senior Manager, Planning Services

ThibeaultF@hcdsb.org



905-632-6314, ext. 107

